



HEPA, HEPB, HEPG, HEPR SERIES
ANSI/UL 1638 COMPLIANT
HEPAS, HEPBS, HEPGS, HEPRS SERIES
ANSI/UL 1638 COMPLIANT



**WALL MOUNT EXPANDER PLATE FOR USE
WITH HSSPKCLP, HSSPK24WLP AND HSSPK24-1575WLP SERIES**

MODELS

- HEPA WALL MOUNT EXPANDER PLATE WITH SELECTABLE CANDELA STROBE, AMBER LENS, ALERT TEXT , WHITE FACEPLATE
- HEPB WALL MOUNT EXPANDER PLATE WITH FIXED 15/75 CANDELA STROBE, BLUE LENS, ALERT TEXT , WHITE FACEPLATE
- HEPG WALL MOUNT EXPANDER PLATE WITH FIXED 15/75 CANDELA STROBE, GREEN LENS, ALERT TEXT , WHITE FACEPLATE
- HEPR WALL MOUNT EXPANDER PLATE WITH FIXED 15/75 CANDELA STROBE, RED LENS, ALERT TEXT , WHITE FACEPLATE
- HEPAS WALL MOUNT SURFACE MOUNT EXPANDER PLATE WITH SELECTABLE CANDELA STROBE, AMBER LENS, ALERT TEXT , WHITE FACEPLATE
- HEPBS WALL MOUNT SURFACE MOUNT EXPANDER PLATE WITH FIXED 15/75 CANDELA STROBE, BLUE LENS, ALERT TEXT , WHITE FACEPLATE
- HEPGS WALL MOUNT SURFACE MOUNT EXPANDER PLATE WITH FIXED 15/75 CANDELA STROBE, GREEN LENS, ALERT TEXT , WHITE FACEPLATE
- HEPRS WALL MOUNT SURFACE MOUNT EXPANDER PLATE WITH FIXED 15/75 CANDELA STROBE, RED LENS, ALERT TEXT , WHITE FACEPLATE

I. INTRODUCTION

The Hochiki America HEPA, HEPB, HEPG, HEPR, HEPAS, HEPBS, HEPGS, HEPRS is an expander plate device with a high quality colored lens strobe for use with the Hochiki America HSSPKCLP Speaker, HSSPK24WLP Series and HSSPK2401575WLP Series to have the ability to mount multiple strobes on a single electrical box for use on a voice evacuation system. The high intensity strobe utilizes a Xenon flash tube that generates a high-intensity flash visible from all listed angles.

The HEPA and HEPAS is provided with a turn dial which provides candela selection at the installation site; see chart below. The HEPB, HEPG, HEPR, HEPBS, HEPGS and HEPRS fixed candela units, available in 15/75 candela intensity only. The HEP strobe is designed to be used on a 24VDC system and features ALERT text on the lens.

The HEPA, HEPB, HEPG, HEPR, HEPAS, HEPBS, HEPGS and HEPRS strobe is listed in compliance with ANSI/UL 1638, Visual Signaling Appliances - Private Mode Emergency and General Signaling for use with Emergency Communication Systems and Private Mode Systems. Additionally, models HEPA and HEPAS comply with the light output dispersion requirements of ANSI/UL 1971 for wall mount applications.

⚠ WARNING Not to be used as a visual public mode alarm notification appliance.

II. LOCATION

This appliance is intended for use in Fire Alarm Systems and Emergency Communication Systems and is to be installed in accordance with this manual, the recommendation of the local authorities having jurisdiction, and other NFPA documents that provide standards on notification appliances for protective signaling systems. The HEPA, HEPB, HEPG, HEPR, HEPAS, HEPBS, HEPGS, HEPRS is intended for indoor installations only; this appliance is **NOT** listed for **outdoor** or drip proof applications.

HEPA AND HEPAS (AMBER COLOR LENS) PRODUCT INFORMATION

Model	Color Lens
HEPA and HEPAS	AMBER

LIGHT OUTPUT IN PERCENTAGE WHEN MEASURED FROM THE FOLLOWING DIRECTIONS - PER UL1971

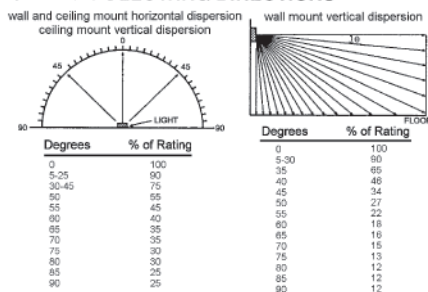

AMBER Lens Strobe Candela Ratings		
Use with HEPA and HEPAS		
Candela	ANSI/UL 1638 On-Axis Candela Rating	ANSI/UL 1971 Measured Candela Rating, Wall Mount
15	15	15
30	30	30
60	60	60
75	75	75
110	110	110

NOTICE: PER NFPA 72, COLORED STROBES ARE TO BE LISTED TO ANSI/UL 1638. ANSI/UL 1971 IS NOT APPLICABLE TO COLORED LENS DEVICES USED IN EMERGENCY COMMUNICATION INSTALLATIONS. HOWEVER, THESE READINGS WERE OBTAINED USING THE LIGHT OUTPUT DISPERSION MEASUREMENT REQUIREMENTS UNDER ANSI/UL 1971.

AMBER Lens Strobe Current Ratings		
Use with HEPA and HEPAS		
Candela	Regulated 24VDC Max. Operating Current (mA)	Regulated 24VFWR Max. Operating Current (mA)
15	78	113
30	96	135
60	137	186
75	180	245
110	224	313

NOTICE: DC VOLTAGE RANGE LIMITS: 16-33V. FWR VOLTAGE RANGE LIMITS: 16-33V. THIS PRODUCT WAS ONLY TESTED TO THE STATED VOLTAGE RANGE(S); DO NOT APPLY 80% AND 110% OF THIS RANGE FOR SYSTEM OPERATION.

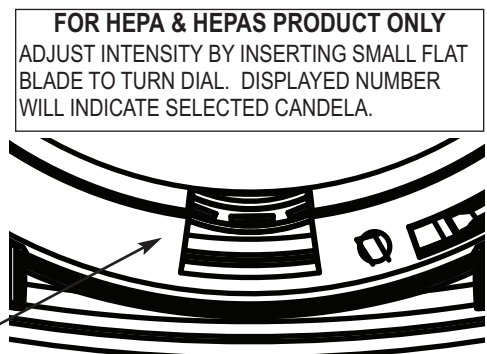
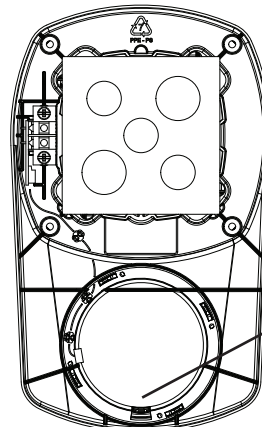

FOR HEPA & HEPAS PRODUCT ONLY
ADJUST INTENSITY BY INSERTING SMALL FLAT BLADE TO TURN DIAL. DISPLAYED NUMBER WILL INDICATE SELECTED CANDELA.

HEPB, HEPBS, HEPG, HEPGS, HEPR AND HEPRS (BLUE, GREEN AND RED COLOR LENS) PRODUCT INFORMATION

Model	Color Lens
HEPB / HEPBS	BLUE
HEPG / HEPGS	GREEN
HEPR / HEPRS	RED

HEP SERIES COLORED LENS STROBE CURRENT RATINGS		
Fixed 15/75* Candela Strobe		
Use with HEPB, HEPG, HEPR, HEPBS, HEPGS and HEPRS Products		
Lens Color	Regulated 24VDC Max. Operating Current (mA)	Regulated 24VFWR Max. Operating Current (mA)
Blue	280	274
Green	360	479
Red	397	438

LIGHT OUTPUT IN PERCENTAGE WHEN MEASURED FROM THE FOLLOWING DIRECTIONS - PER UL1638

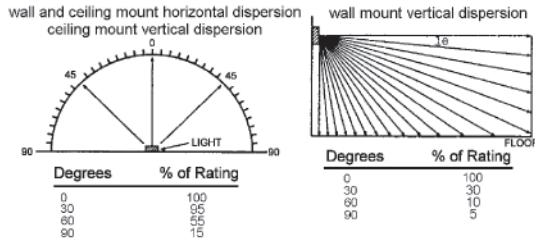

*The HEPB, HEPG, HEPR, HEPBS, HEPGS and HEPRS has a fixed candela rating of 15/75 per ANSI/UL 1638.

NOTICE: DC VOLTAGE RANGE LIMITS: 16-33V. FWR VOLTAGE RANGE LIMITS: 16-33V. THIS PRODUCT WAS ONLY TESTED TO THE STATED VOLTAGE RANGE(S); DO NOT APPLY 80% AND 110% OF THIS RANGE FOR SYSTEM OPERATION.

IV. WIRING

CAUTION:
WHEN INSTALLING, ROUTE FIELD WIRING AWAY FROM SHARP PROJECTIONS, CORNERS AND INTERNAL COMPONENTS.

CAUTION: DO NOT USE LOOPED WIRE UNDER TERMINALS. BREAK WIRE RUN TO PROVIDE SUPERVISION OF CONNECTION.

WIRE CONDUCTIVITY

18 AWG	60
16 AWG	95
14 AWG	153
12 AWG	244

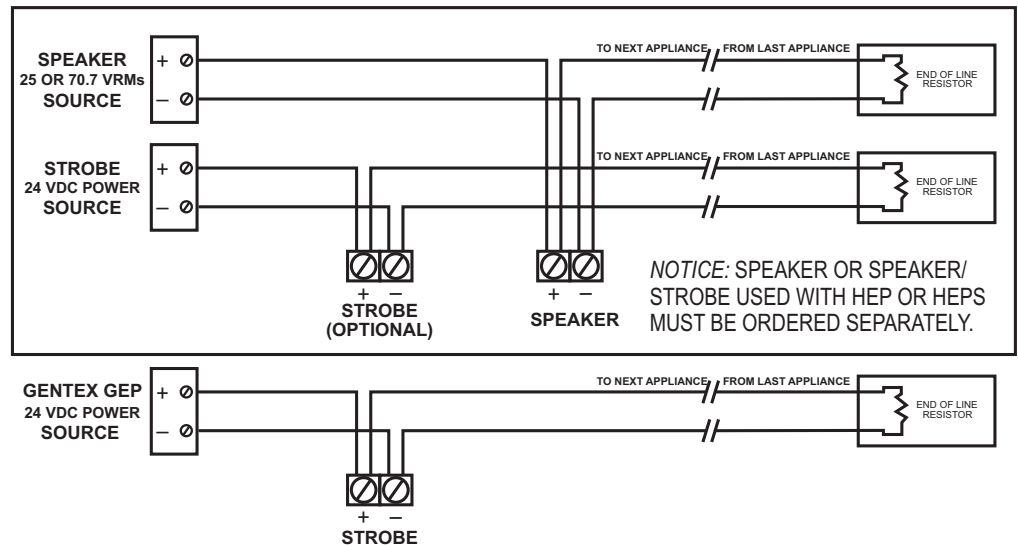

NOTICE: SPEAKER OR SPEAKER/STROBE USED WITH HEP OR HEPBS MUST BE ORDERED SEPARATELY.

*MAX. WIRE DISTANCE (IN FEET) = $\frac{\text{PANEL VOLTAGE} - \text{DEVICE MINIMUM VOLTAGE}}{\text{TOTAL CURRENT DRAW}} \times \text{WIRE CONDUCTIVITY (STROBE ONLY)}$

* INCLUDES WIRE TO AND FROM APPLIANCE.
ASSUMES ALL APPLIANCES ARE AT THE END OF WIRE RUN (WORST CASE).
NOTICE: APPLIES ONLY TO REGULATED SUPPLIES.

NOTICE:

- USE THE HOCHIKI AMERICA SYNCHRONIZATION PROTOCOL TO ALLOW THE FACP TO SYNCHRONIZE THE STROBES.
- ALL STROBES ARE DESIGNED TO FLASH AS SPECIFIED WITH CONTINUOUS APPLIED VOLTAGE. THIS APPLIANCE IS NOT RECOMMENDED FOR USE ON CODED OR PULSING SIGNALING CIRCUITS. HOWEVER, USE OF THE HOCHIKI AMERICA HAVSM CONTROL MODULE IS PERMITTED TO SYNCHRONIZE THE STROBE.
- REFERENCE HOCHIKI AMERICA HAVSM CONTROL MODULE MANUAL (550-0539, DATED 3-4-11) FOR STROBE SYNCHRONIZATION MODULE WIRING DIAGRAMS. HAVSM MANUAL CAN BE OBTAINED AT [HTTP://WWW.HOCHIKI.COM](http://www.hochiki.com) OR CALL HOCHIKI AMERICA CORPORATION AT 714-522-2246.

V. MOUNTING ROUGH-IN BOX AND RUN WIRING

1. Attach model HEP to flush mounted box or model HEPS for surface mount applications with 2 of the 6 provided #8-32 x 3/4" screws.
2. Snap in mounting ring, noting key location and "this side out" text locations.
3. Wire HEP strobe and HSSPKCLP, HSSPK24WLP or HSSPK24-1575WLP (SOLD SEPARATELY) as shown in WIRING Section of this manual.
4. Connect HSSPKCLP, HSSPK24WLP or HSSPK24-1575WLP to HEP strobe using remaining 4 #8-32 x 3/4" screws.

NOTICE:

- "LEVEL" LINE TO AID IN ALIGNMENT. IF ADDITIONAL SUPPORT IS DESIRED, ADDITIONAL SCREWS (NOT SUPPLIED) MAY BE ADDED IN FOUR BASE LOCATIONS (SEE DIAGRAM BELOW).
- DO NOT USE THE SCREWS PROVIDED WITH THE HSSPKCLP, HSSPK24WLP OR HSSPK24-1575WLP WITH THE INSTALLATION OF HEP OR HEPS SERIES. USE ONLY SCREWS PROVIDED WITH HEP OR HEPS FOR SPEAKER OR SPEAKER/STROBE INSTALLATION.
- WIRE STRIP GUIDE PROVIDED ON HEP OR HEPS SERIES.

**WALL MOUNT - HEP PLATE
EXPANDED VIEW WITH MOUNTING RING**

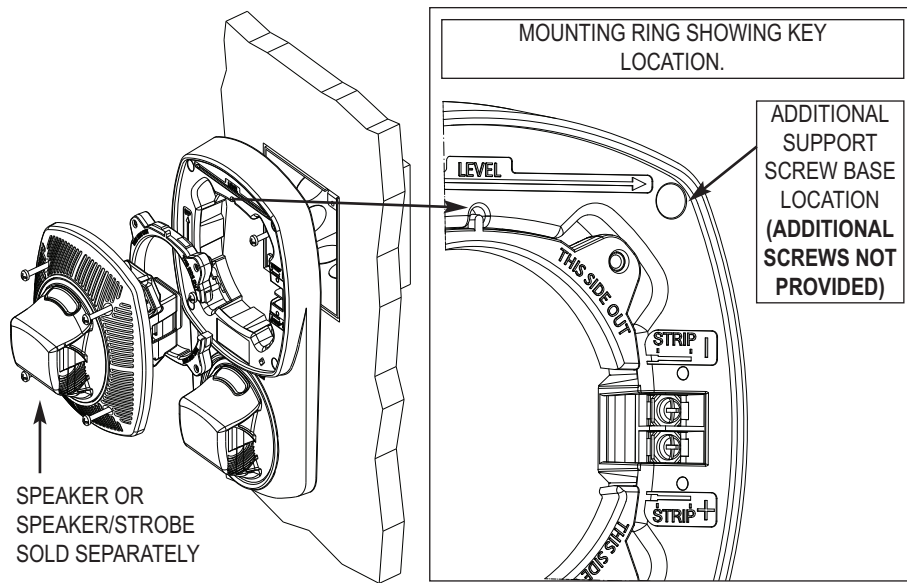

**WALL MOUNT - HEP PLATE
INSTALLED HEP PLATE WITH SPEAKER/STROBE**

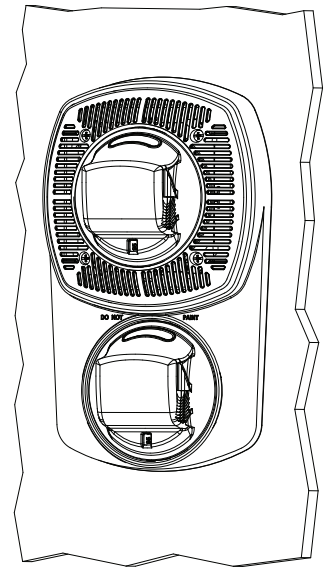

**WALL MOUNT - HEPS SURFACE MOUNT PLATE
TO 4" SQUARE x 2 1/8" DEEP METALLIC BACK BOX**

NOTICE: FOR SURFACE MOUNT APPLICATION MATERIAL MUST BE REMOVED FROM SIDE OR TOP AREAS TO ACCOMMODATE SPECIFIC CONDUIT AND FITTINGS. THE HEPS CAN ACCOMMODATE 1/2 AND 3/4 CONDUIT WITH APPROPRIATE CUTOUTS.

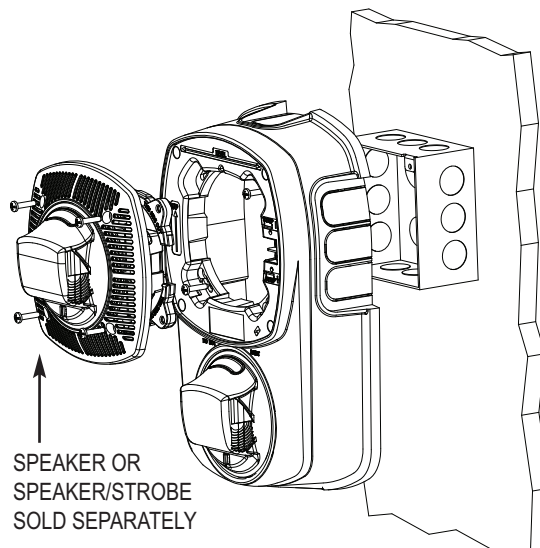

**WALL MOUNT - HEPS SURFACE MOUNT PLATE
INSTALLED HEPS PLATE WITH SPEAKER/STROBE**

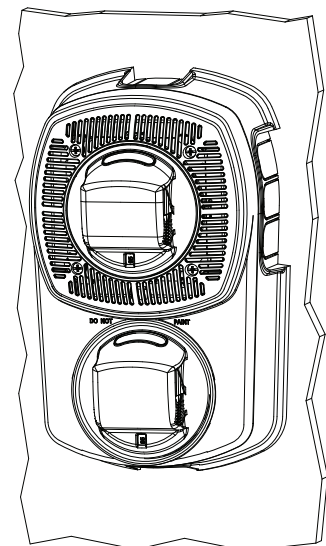

V. CHECKOUT AND TROUBLESHOOTING

1. Supply power to the system control panel. The auxiliary signaling device should not be activated.
2. If the signal is activated:
 - a. Check all smoke and fire detectors in the system to make sure they have not been activated.
 - b. Check all wiring connections to make sure the signal detection circuits are not reversed or shorted together. Check wire color codes and traces.
3. To test the speaker or speaker/strobe product series and other signaling appliances, trip the auxiliary panel, activate alarm circuit at the main control panel or activate one of the fire detection units in the system. All auxiliary signals should be activated.
4. An operational test on this product should be conducted in accordance with National Standards or at a minimum annually and more often if dictated by local and state codes or authorities having jurisdiction.



WARNING

THIS APPLIANCE WILL NOT OPERATE WITHOUT ELECTRICAL POWER. AS FIRES FREQUENTLY CAUSE POWER INTERRUPTIONS, HOCHIKI AMERICA SUGGESTS YOU DISCUSS FURTHER SAFEGUARDS WITH YOUR LOCAL FIRE PROTECTION SPECIALIST.

VI. TO RETURN AN APPLIANCE

Should you experience problems with your appliance, proceed as follows:

1. Turn off electrical power to the auxiliary alarm circuit.
2. Unscrew the unit from the mounting box.
3. Disconnect the unit from the field wiring. Reconnect the two positive supply voltage circuits (red wires) and the two negative supply voltage circuits (black wires) of the auxiliary alarm circuit to maintain power to the other auxiliary alarm appliances in the system.
4. Carefully pack the defective unit (the manufacturer cannot be responsible for damage due to shipping or mishandling). Include your return address and complete details as to the nature of the difficulties being experienced and date of installation.
5. Return to: Hochiki America Corporation, 7051 Village Drive, Suite 100, Buena Park CA 90621. Prior to returning, call the Hochiki America Field Service Department at 714-522-2246 to obtain a RMA Number from our return department.

LIMITED WARRANTY

For a period of 36 months from the date of purchase or a maximum of 42 months from the date of manufacture, Hochiki America warrants to you the original purchaser that your appliance will be free from defects in workmanship, materials and construction under normal use and service. If a defect in workmanship, materials and construction should cause your appliance to become inoperative within the warranty period, Hochiki America will repair your appliance or furnish you with a new or rebuilt appliance without charge to you except for postage required to return the appliance to us. Hochiki America will not reimburse you for repairs or replacement parts provided by other parties. Your repaired or replacement appliance will be returned to you free of charge and it will be covered under the warranty for the balance of the warranty period.

The warranty is void if our inspection of your appliance shows that the damage or failure was caused by abuse, misuse, abnormal usage, faulty installation, improper maintenance or repairs other than those performed by us.

ANY WARRANTIES IMPLIED UNDER ANY STATE LAW INCLUDING IMPLIED WARRANTIES OF MERCHANTABILITY OR FITNESS FOR A PARTICULAR PURPOSE APPLY ONLY FOR THE WARRANTY PERIOD SPECIFIED ABOVE. PLEASE NOTE THAT SOME STATES DO NOT ALLOW LIMITATION ON HOW LONG AN IMPLIED WARRANTY LASTS. SO THE ABOVE LIMITATION MAY NOT APPLY TO YOU. HOCHIKI AMERICA WILL NOT BE LIABLE FOR ANY LOSS, DAMAGE, INCIDENTAL OR CONSEQUENTIAL DAMAGES OF ANY KIND ARISING IN CONNECTION WITH THE SALE, USE OR REPAIR OF THIS APPLIANCE. THE MAXIMUM LIABILITY OF HOCHIKI AMERICA SHALL NOT IN ANY CASE EXCEED THE PURCHASE PRICE PAID BY YOU FOR THE APPLIANCE. PLEASE NOTE THAT SOME STATES DO NOT ALLOW THE EXCLUSION OR LIMITATION OF INCIDENTAL OR CONSEQUENTIAL DAMAGES, SO THE ABOVE LIMITATION OR EXCLUSION MAY NOT APPLY TO YOU.

If a defect in workmanship, materials or construction should cause your appliance to become inoperable within the warranty period, you must return the appliance to Hochiki America postage prepaid. You must prove to the satisfaction of Hochiki America the date of purchase of your appliance. Warranty service may only be performed by Hochiki America personnel at Hochiki America's facilities in Buena Park, California. You must also pack the appliance to minimize the risk of it being damaged in transit. You must also enclose a return address. Appliances returned for warranty service should be sent to: Hochiki America Corporation, 7051 Village Drive, Suite 100, Buena Park CA 90621. If we receive an appliance in a damaged condition as the result of shipping, we will notify you and you must seek a claim with the shipper.

THIS WARRANTY GIVES YOU SPECIFIC LEGAL RIGHTS AND YOU MAY ALSO HAVE OTHER RIGHTS WHICH VARY FROM STATE TO STATE.

Important Notice:

These materials have been prepared by Hochiki America Corporation ("Hochiki America") for informational purposes only, are necessarily summary, and are not purported to serve as legal advice and should not be used as such. Hochiki America makes no representations and warranties, express or implied, that these materials are complete and accurate, up-to-date, or in compliance with all relevant local, state and federal laws, regulations and rules. The materials do not address all legal considerations as there is inevitable uncertainty regarding interpretation of laws, regulations and rules and the application of such laws, regulations and rules to particular fact patterns. Each person's activities can differently affect the obligations that exist under applicable laws, regulations or rules. Therefore, these materials should be used only for informational purposes and should not be used as a substitute for seeking professional legal advice. Hochiki America will not be responsible for any action or failure to act in reliance upon the information contained in this material.

Hochiki America Corporation
7051 Village Drive, Suite 100
Buena Park, CA 90621 USA
Phone: 714-522-2246
www.hochiki.com

550-0590-AAA

11/01/13